

# द्वि. वि. प्रा. द्वारका उपशहर परियोजना

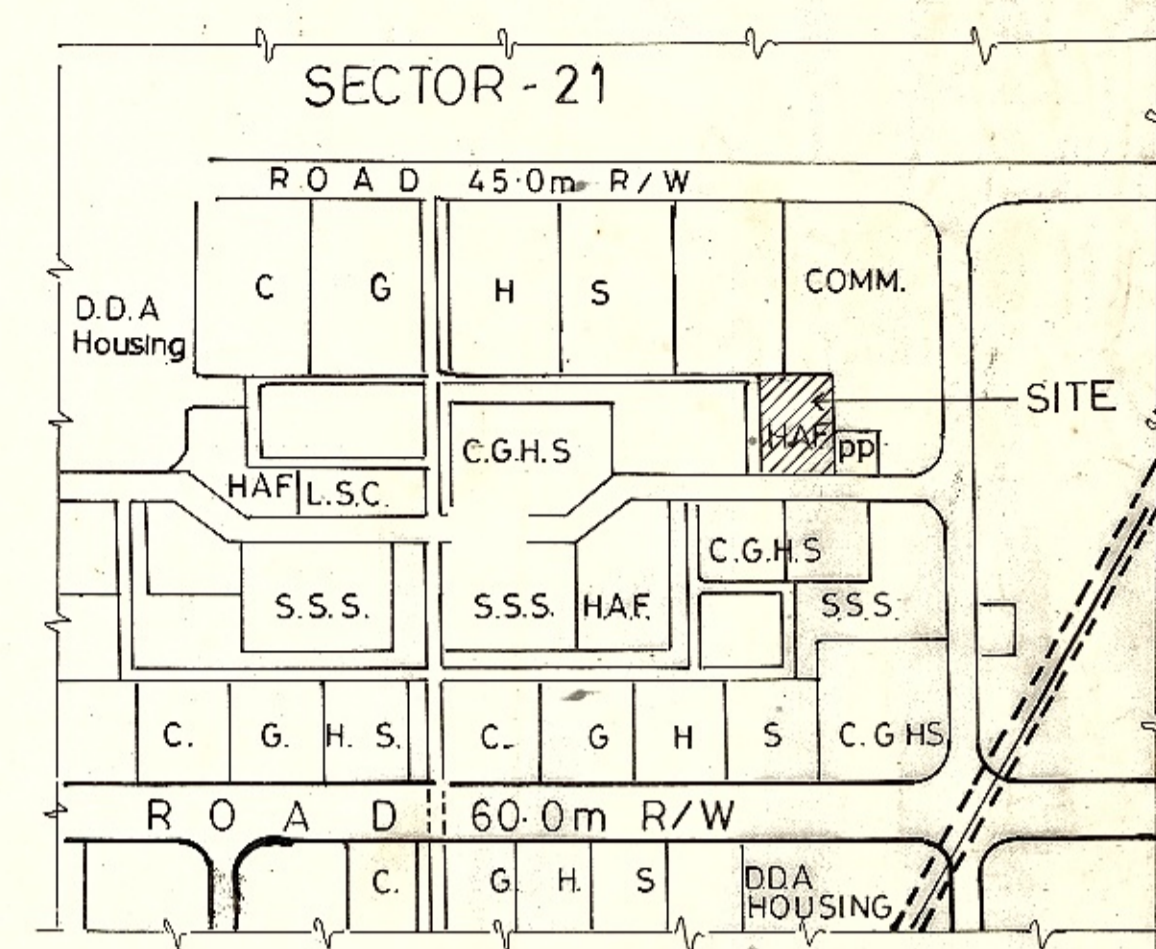

KEY PLAN

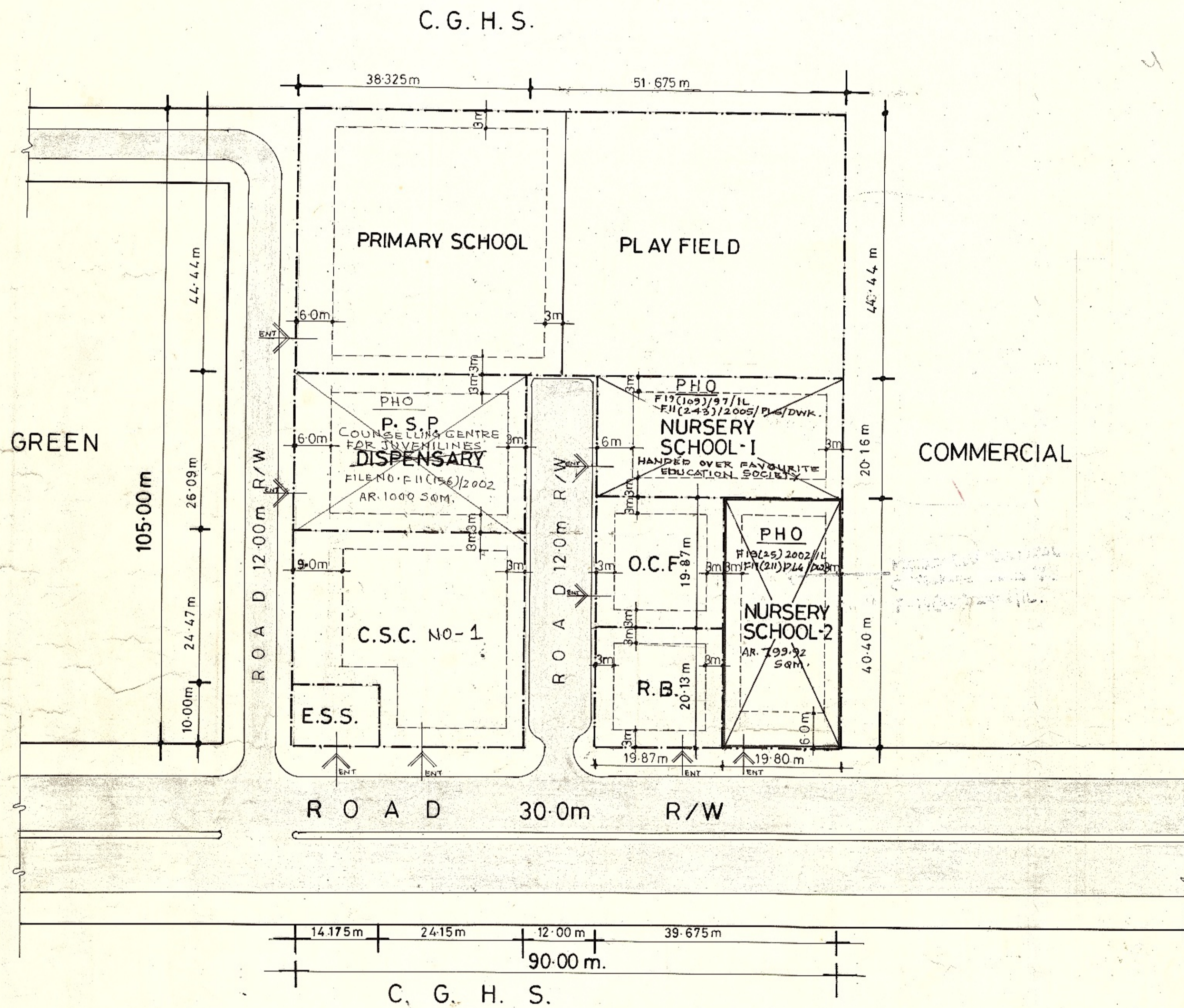

## AREA STATEMENT

TOTAL AREA OF THE PLOT 9450.00sq.m.

Sr. NO.	FACILITY	PROPOSED AREA IN SQ.MT.	GR. COVR.	F.A.R.	MAX. HT. IN MTS.
1	PRIMARY SCHOOL	4000.00	33%	100	14
2	NURSERY SCHOOL-I	799.848	33.33%	66.66%	11
3	NURSERY SCHOOL II	799.92	33.33%	66.66%	11
4	C.S.C. M.B.+VB	1179.31	40%	60	8
5	DISPENSARY	1000.00	33.33%	100	14
6	RELIGIOUS	399.98	33.33%	66.66%	8
7	O.C.F.	394.81	33.33%	66.66%	8
8	E.S.S.	141.75	-	-	-
9	CIRCULATION	734.382	-	-	-

## OTHER NORMS AS PER M.P.D. 2001

### NOTES:

- APPROVED BY COMMISSIONER PLG. IN FILE NO.F-8(10)/94/DWK/HAF/B/PT-1 DATED 14.2.97 ON PAGE NO. 14N.
- FEASIBILITY OBTAINED FROM EX. ENGINEER W.D.10 D.D.A VIDE LETTER NO.WD-10/3(97)97/D.D.A./2672 DATED 17.5.97.
- MINOR MODIFICATION IN H.A.F. PKT. A. SEC. 22 FOR DISPENSARY SITE HAS BEEN CONVERTED TO P.S.P. PLOT FOR COUNSELLING CENTRE FOR JOLENVILINES, AS PER APPROVAL OF COMM. (PLG) DDA ON PAGE 2/N IN FILE NO.FN(156) 2002/PLG. DWK DT. 8-3-2002.

- THE PLAN IS SUBJECT TO MODIFICATIONS WITHIN THE FRAMEWORK OF MASTER PLAN/ZONAL PLAN.
- IT IS FOR PLANNING PURPOSE & IS NOT FIT TO BE PRODUCED IN THE COURT OF LAW FOR PROPERTY DISPUTES.
- ALL THE DIMENSIONS & AREA GIVEN IN THE PLAN ARE SUBJECT TO CONFIRMATION OF OWNERSHIP/ALLOTMENT STATUS & DEMARCATIONS/FEASIBILITY REPORT FROM THE DDA LANDS & ENGINEERING WING RESPECTIVELY.

## HOUSING AREA FACILITY

PLOT NO. A

SECTOR-22

## LAY OUT PLAN

0 5 10 15 20 25 30 35 SCALE 1500		DRG. NO. DWK/SP-22/HAF/94/10223	
PLG D/MAN	RUPINDER PLG ASST.	DATE	
SUMET AGGARWAL ASST DIRECTOR	ANIL BARAI JT DIRECTOR	V. RISBUD PROJECT DIRECTOR	
दिल्ली	विकास	प्राधिकरण	

DWARAKA SUB-CITY (PAPANKALA)